

01 B1+B2-C-02-GA-A-PRP . 1 : 100

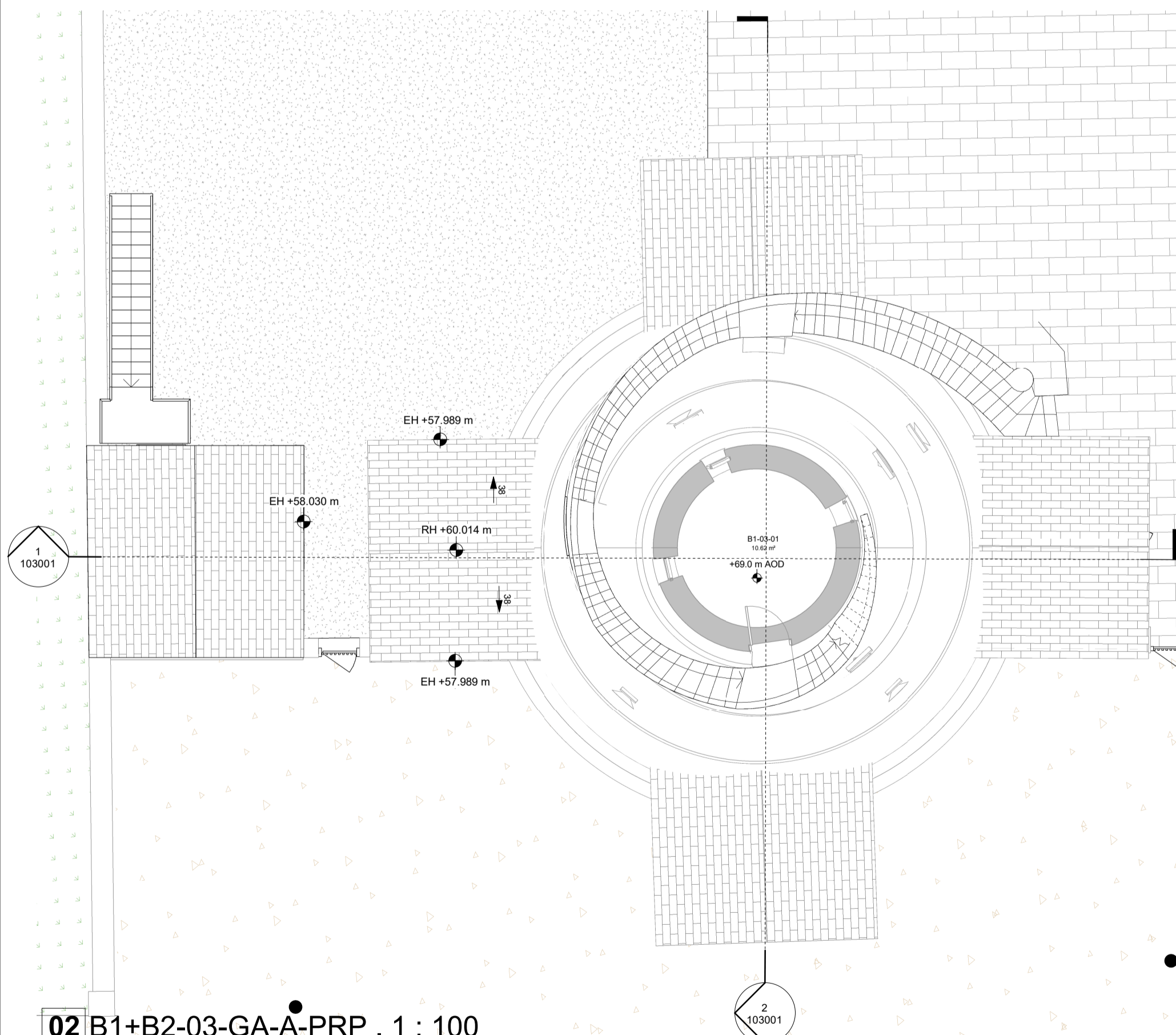

02 B1+B2-03-GA-A-PRP . 1 : 100

Proposed Second - Fifth Floor Plan - The Wonderful Barn and Barnhall House  
Scale 1:100

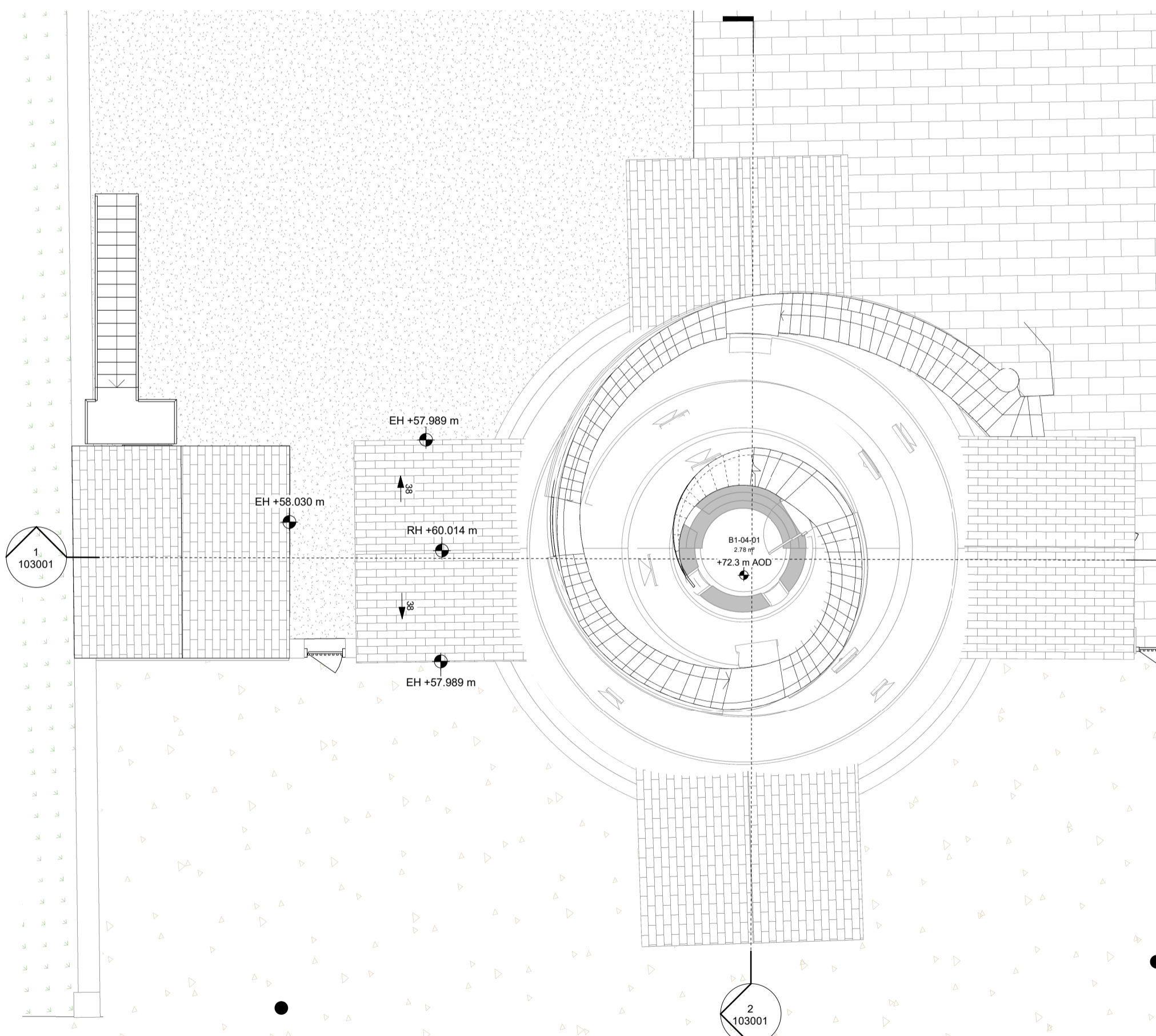

03 B1+B2-04-GA-A-PRP . 1 : 100

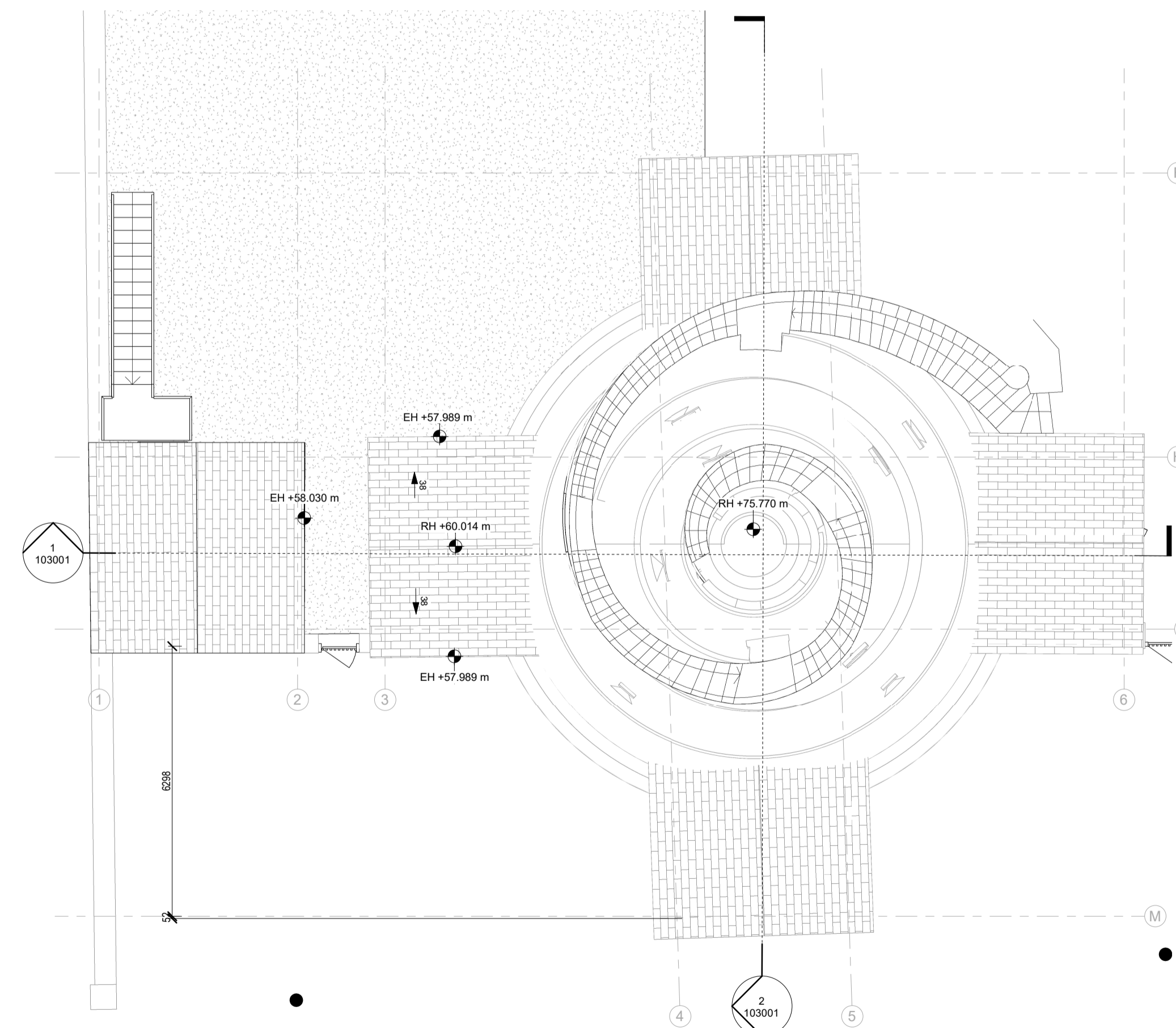

04 B1+B2-05-GA-A-PRP . 1 : 100

Revision	Date	Description	Issued	Checked
P1	31.05.2024	Part 8 Planning Application to Kildare County Council	AOD	DM
P2	04.06.2024	Part 8 Planning Application Revisions		



**Notes**  
Do not scale drawings. All dimensions should be checked on site. Errors to be reported to Architect. To be read in conjunction with all relevant Architect's services and engineers's drawings. Contractors, sub-contractors and suppliers must verify any critical dimensions on site prior to fabrication of any building element. Any discrepancies are to be reported to the Architect. This drawing should be read in conjunction with all relevant specifications, engineers and specialist consultant's information. Any discrepancies must be reported prior to installation.  
No information in this drawing/specification should be interpreted as design related to fire safety or fire performance. As required by the Professional Indemnity market we exclude any liability whatsoever for the fire safety of buildings, products, materials or systems and assume these will be by others such as a Fire Engineer and Specialist Contractor Design.  
**Copyright**  
Copyright Metropolitan Workshop LLP  
No implied license exists. This drawing should not be used to calculate areas for the purpose of valuation. Do not scale this drawing. All dimensions to be checked on site by the contractor and such dimensions to be their (his/her) responsibility. All work must comply with the relevant British Standards and Building Regulations. Drawing's error and omissions to be reported to the architect.  
This drawing was prepared in part, based on survey information provided by others. Whilst this information is believed to be reliable, Metropolitan Workshop assumes no responsibility for the accuracy of this information or any errors or omissions that may have been incorporated into it as a result of incorrect information provided by others.

**Key**

N

Existing Fabric

Proposed Fabric

Building A1 - North Dovecote  
Building A2 - South Dovecote  
Building B1 - The Wonderful Barn  
Building B2 - Potato House  
Building C - Barnhall House  
Building D1 - East Stable  
Building D2 - West Stable  
Building D3 - Cafe Extension  
Building E - Allotment Facilities  
Courtyard 1  
Courtyard 2  
Courtyard 3

**Metropolitan Workshop**

Tower 2, Fumbally Lane, Dublin  
D08 N2N6

00 353 (0)1 531 4889  
www.metwork.ie

Project:	The Wonderful Barn							
Client:	Kildare County Council							
Location:	Leixlip, Co. Kildare							
Title:	Proposed Second - Fifth Floor Plan - The Wonderful Barn							
Date:	04.06.2024							
Scale:	As Indicated @ A1							
Drawing Number:	2123							
Project	Originator	Volume	Level	Type	Role	Reference	Suitability	Revision
2123	MET	B1	ZZ	DR	A	101005	S4	P2